



**Haggie
Distribution**

PRODUCT CATALOGUE



CHAIN

IN PARTNERSHIP WITH



**McKinnon
Chain**



INTRODUCTION

We pride ourselves on our ability to provide durable and reliable chains that can withstand even the toughest conditions. Whether you require chains for agricultural machinery, construction equipment, or industrial applications, we have the skills and knowledge to deliver the perfect product for your specific requirements.

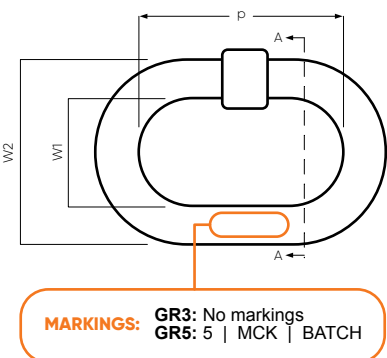
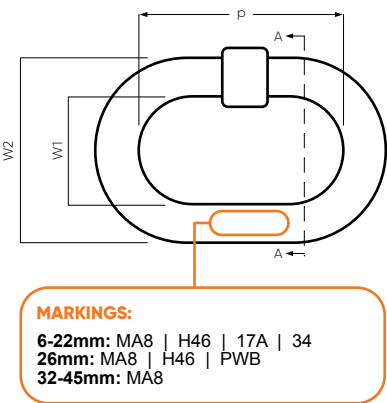
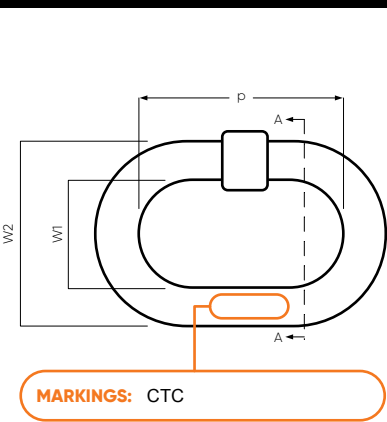

CTC

Certified Transport Chain is available in two sizes, that being 10mm & 13mm diameter. The chains are manufactured from quality steel, thus making it suitable for simple and complex assemblies. Certified Transport Chains and components are combined to make secure assemblies typically used to tie-down loads for transport. Chain manufactured in accordance with SANS 10187-1:2009.

MAX ALLOY

The complete range of Max-Alloy® chain, including sizes 7mm - 32mm diameters is manufactured in South Africa in both Grade 8 and Grade 10, while sizes 36mm - 50mm are available in grade 8. The steel is supplied by a local steel manufacturer in accordance with national and international standards specified for short link lifting chain. Max-Alloy® is a bespoke heat treated, fine grain steel developed for use in chain slings for lifting applications. Gr80 short link chain manufactured in accordance with SANS 189:2010 & EN 818-2.

MAX-LINK / MINING CHAIN

Max-link refers to Grade 3 and Grade 5 Long Link and Extra Long Link chain that are primarily used in underground mining. The chain is well suited for underground pipe and equipment suspensions applications in the shaft mining industry. Manufactured in accordance with SANS 251 & SANS 189.

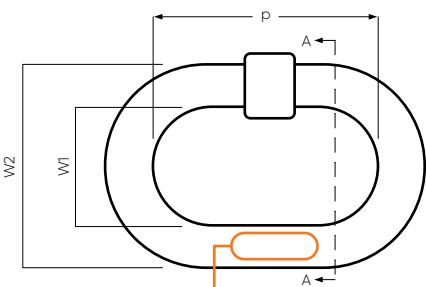
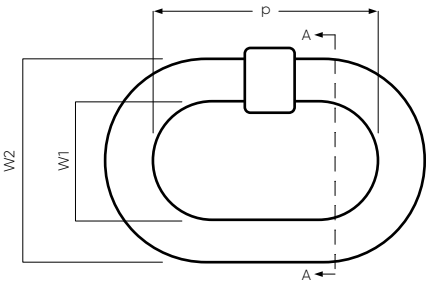

MARKINGS: GR1: 1 | YY | N
GR2: 2 | YY | N

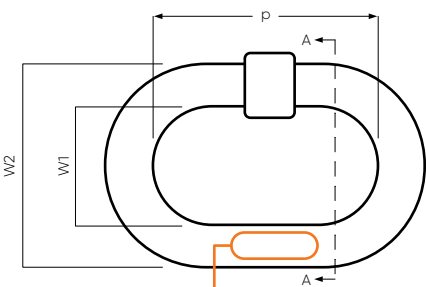

MARKINGS: MCK | TRACE CODE

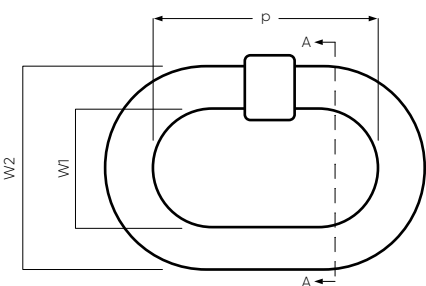

MARINE CHAIN

McKinnon Chain offers a wide variety of chain suitable for marine and mooring applications. These chains are manufactured to national and international standards, with product integrity fit to withstand the harsh coastal environment. The product can be supplied in either painted, galvanized or zinc thermal diffused finish.

AGRICULTURAL CHAIN

Super X Short Link Chain is a special steel chain developed to withstand the arduous and extreme conditions encountered in the sugar and forestry industries. The unique properties of McKinnon agricultural chain make it ideally suited for applications such as bundling chain, spiller trailer chain or for log skidding and timber bundling. Chain manufactured in accordance with SANS 189 & DIN 22252 - Sept. 1983.

LOAD & HAND CHAIN

Load chain is manufactured from Alloy Steel to meet GR80 properties. The chain is calibrated to a fine tolerance and is used on manually operated chain hoists. Hand chain is manufactured for a variety of chain blocks and roller-shutter-doors, calibrated to a fine tolerance and are available in self-colour and zinc electroplated finish. Manufactured in accordance with ISO 3077:1984, SANS 16877, 16872 & EN818-7. SANS 1592:1993.

HARDWARE CHAIN

Hardware chain is ideally suited for most D.I.Y. and general purpose applications. The chain is available in sizes 3,0mm to 10,0mm diameters and is supplied in measured 30m lengths or in full drums.





**Haggie
Distribution**

JOHANNESBURG

+27 (0)11 601 8400
johannesburgsales@haggie.co.za

DURBAN

+27 (0)31 450 7400
dbnsales@haggie.co.za

KURUMAN

+27 (0)53 712 1311
kurumansales@haggie.co.za

KLERKSDORP

+27 (0)18 469 2523
klerksdorpsales@haggie.co.za

EMALAHLENI

+27 (0)13 699 9044
emalahlenisales@haggie.co.za

MOSSEL BAY

+27 (0)44 695 1516
mosselbaysales@haggie.co.za

CAPE TOWN

+27 (0)21 508 1500
capetownsales@haggie.co.za

EAST LONDON

+27 (0)43 722 1875
eastlondonsales@haggie.co.za

PIETERMARITZBURG

+27 (0)33 846 1350
pietermaritzburgsales@haggie.co.za

RUSTENBURG

+27 (0)14 592 9714
rustenburgsales@haggie.co.za

GQEBERHA

+27 (0)41 453 2090
gqeberhasales@haggie.co.za

RICHARDS BAY

+27 (0)35 789 1436
richardsbaysales@haggie.co.za